

ALCOVE SLIDING SHOWER SERIES

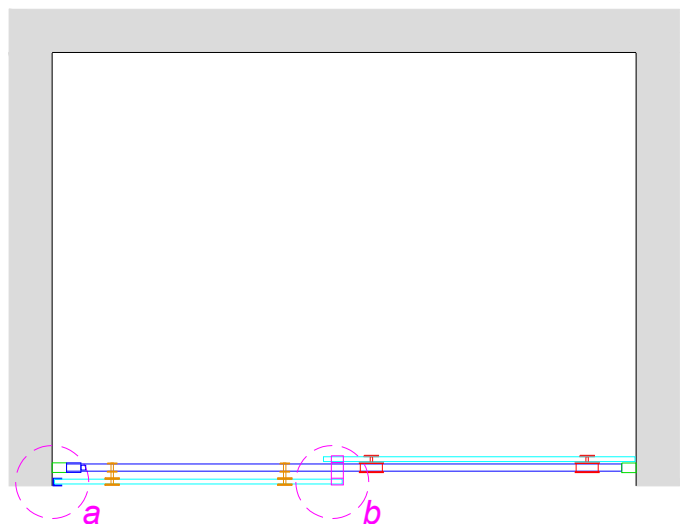

TOP VIEW

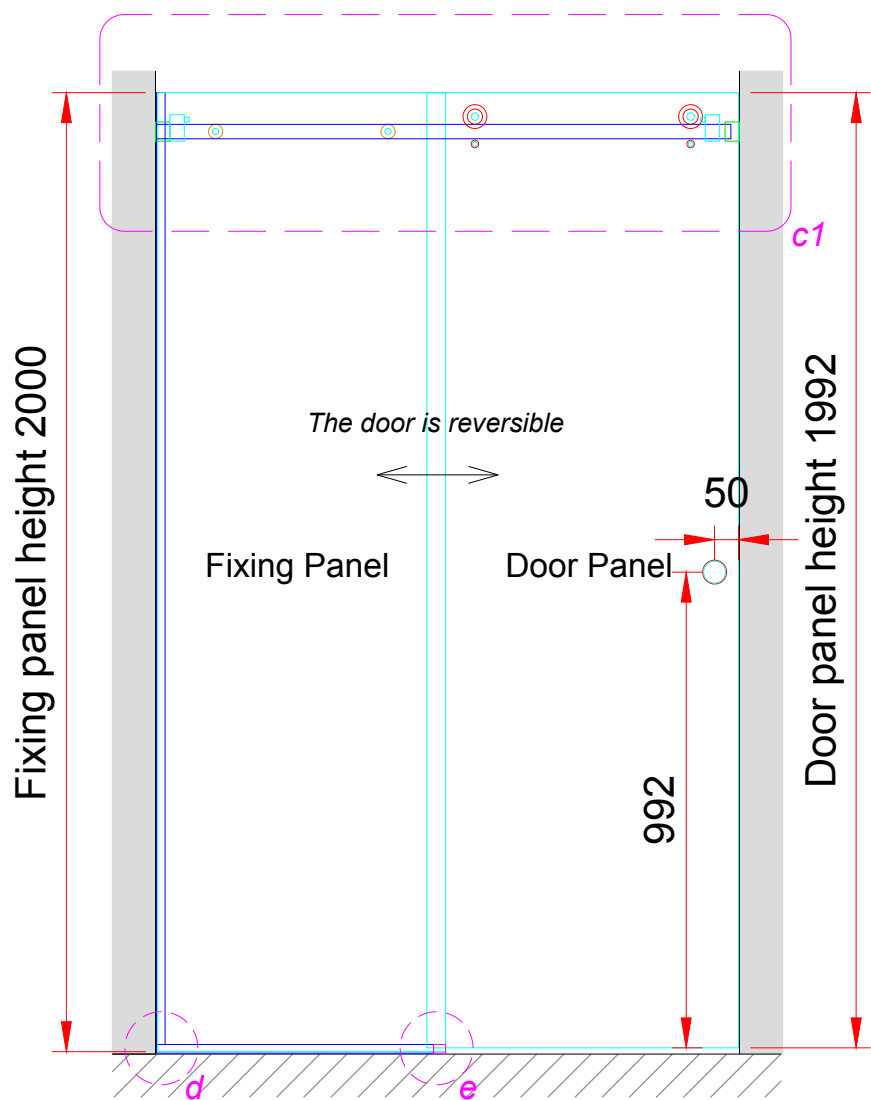

LEGEND	
1	Shower Channel
2	Sliding Bar
3	Upper Roller
4	Rail Connector
5	Stabiliser Guide
6	Stoppers
7	Rail to Wall Bracket
8	Door Ring
9	Floor Guide

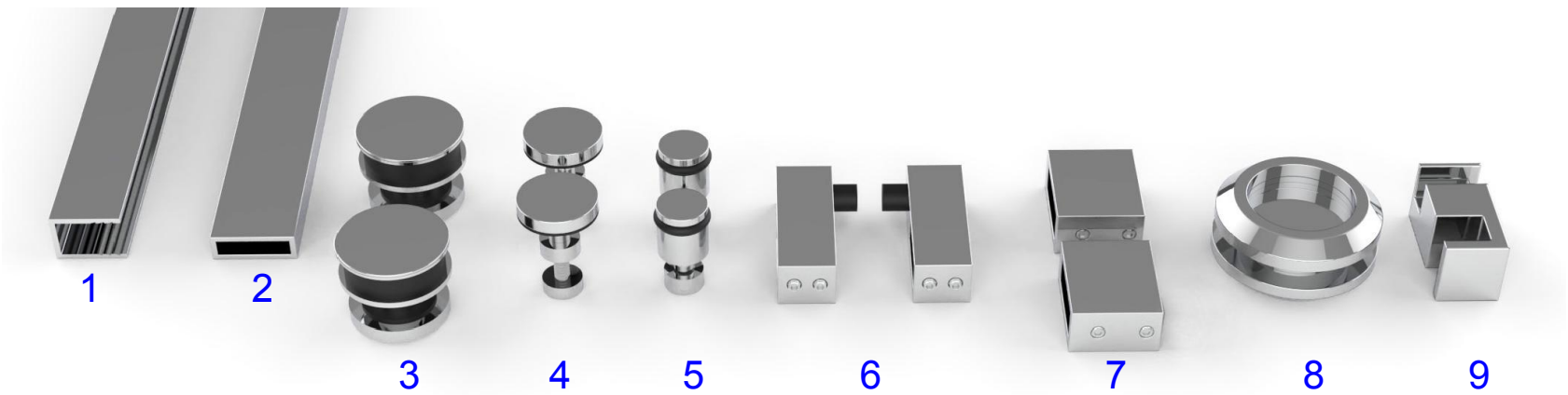

* Sliding Shower Hardware Pack

For more detailed information, please contact the team: email sales@grandglass.co.nz ph 09 478 9778 or 027 755 7705 www.grandglass.co.nz



ADD: 18a Parkway Drive, Rosedale. PH: 09 478 9778 , 027 755 7705

Grand Glass Sliding Shower Installation Guide

Complies with NZS3604:2011

Drawn By : SW	Date : 1/29/2025	Paper Size : A3
Checked By : JQ		Scale : NTS
Drawing No. : GGH-SS01		Rev. No. : 0
		Sht. No. : 1

FIXING DETAIL (ALCOVE)

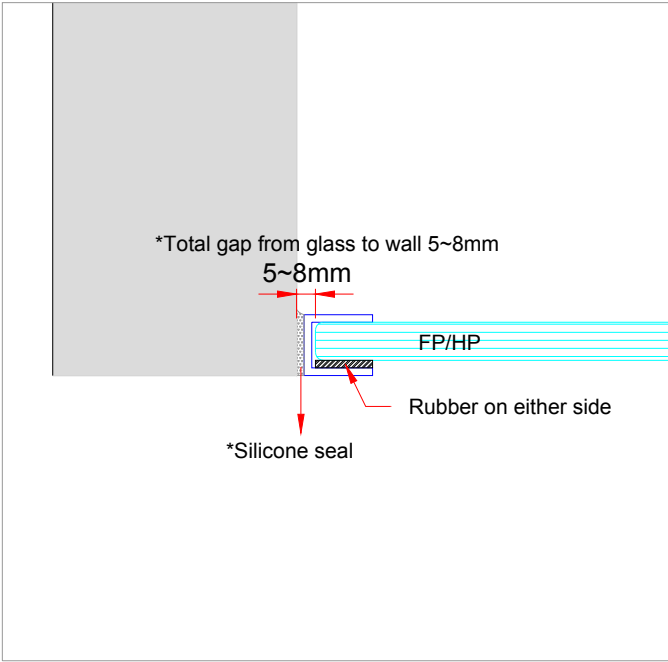

FIXING DETAIL a

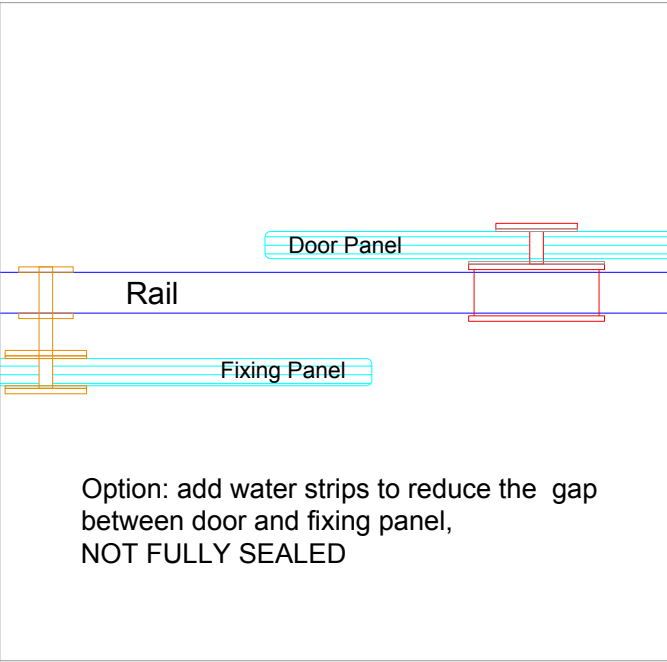

FIXING DETAIL b

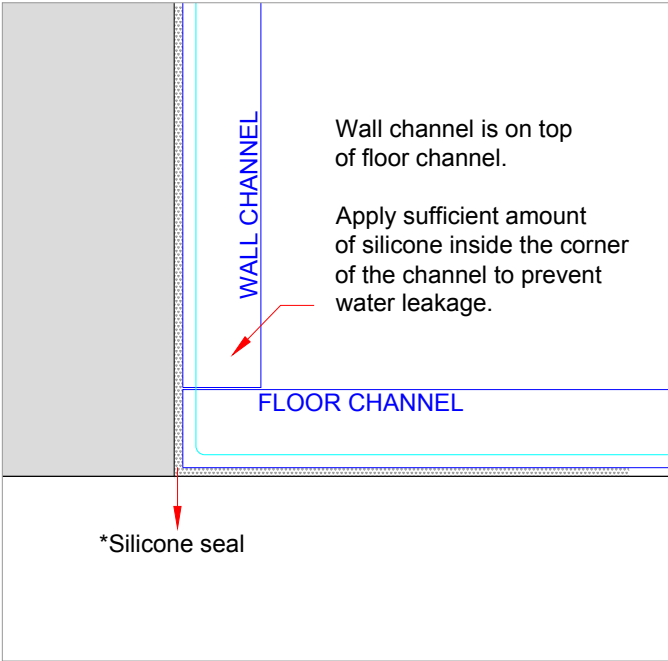

FIXING DETAIL d

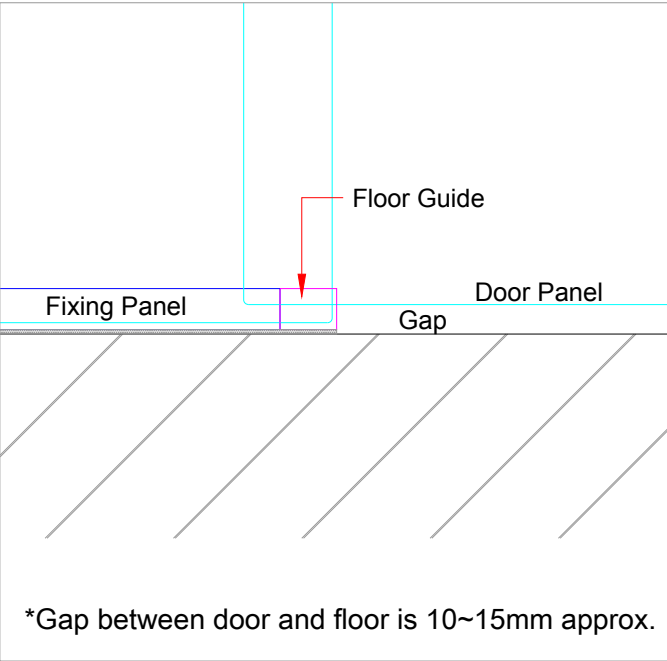

FIXING DETAIL e

Important:

Before you install your project, please read this installation guide carefully, consider the gap between each part, calculate the exact length before cutting.

The corners and edges of toughened glass are its weakest points, so ensure they are well-protected during installation.

Always use rubber spacers to separate stainless steel hardware from the glass to avoid damage.

After completing the installation, it is essential to clean both the glass and the hardware. Proper cleaning of the glass helps maintain its protective coating, and cleaning the hardware removes any metal debris from the installation process, preventing potential rust.

Additionally, regular cleaning afterward is recommended to ensure long-term durability and maintain optimal performance.

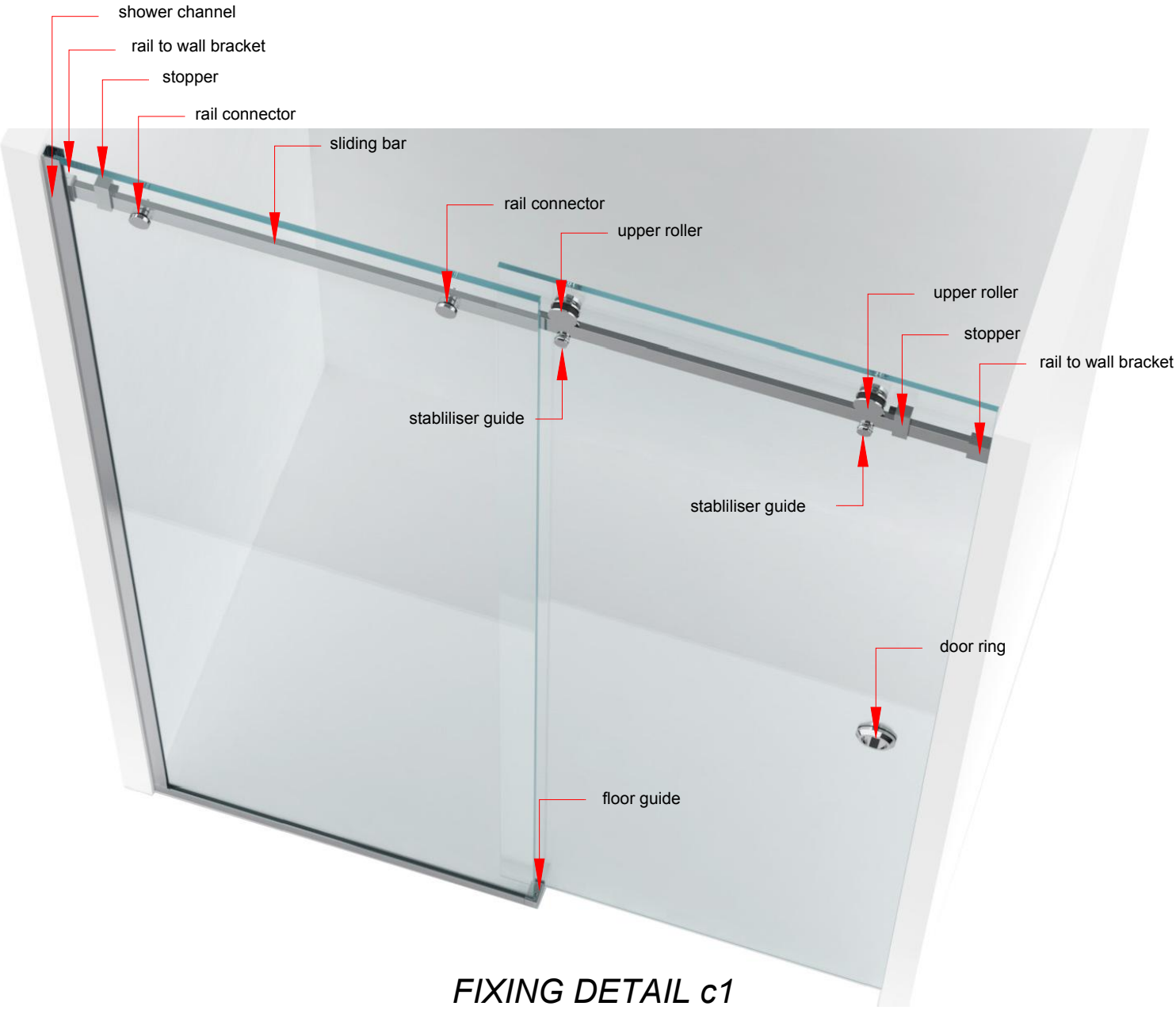

FIXING DETAIL c1

RECTANGLE SLIDING SHOWER SERIES

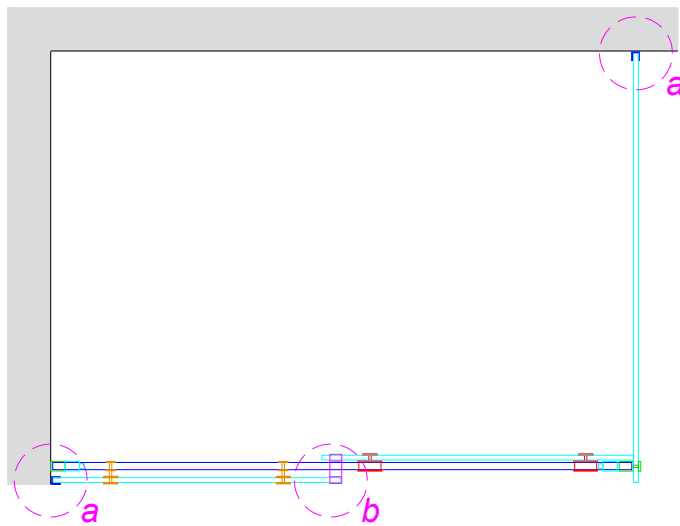

TOP VIEW

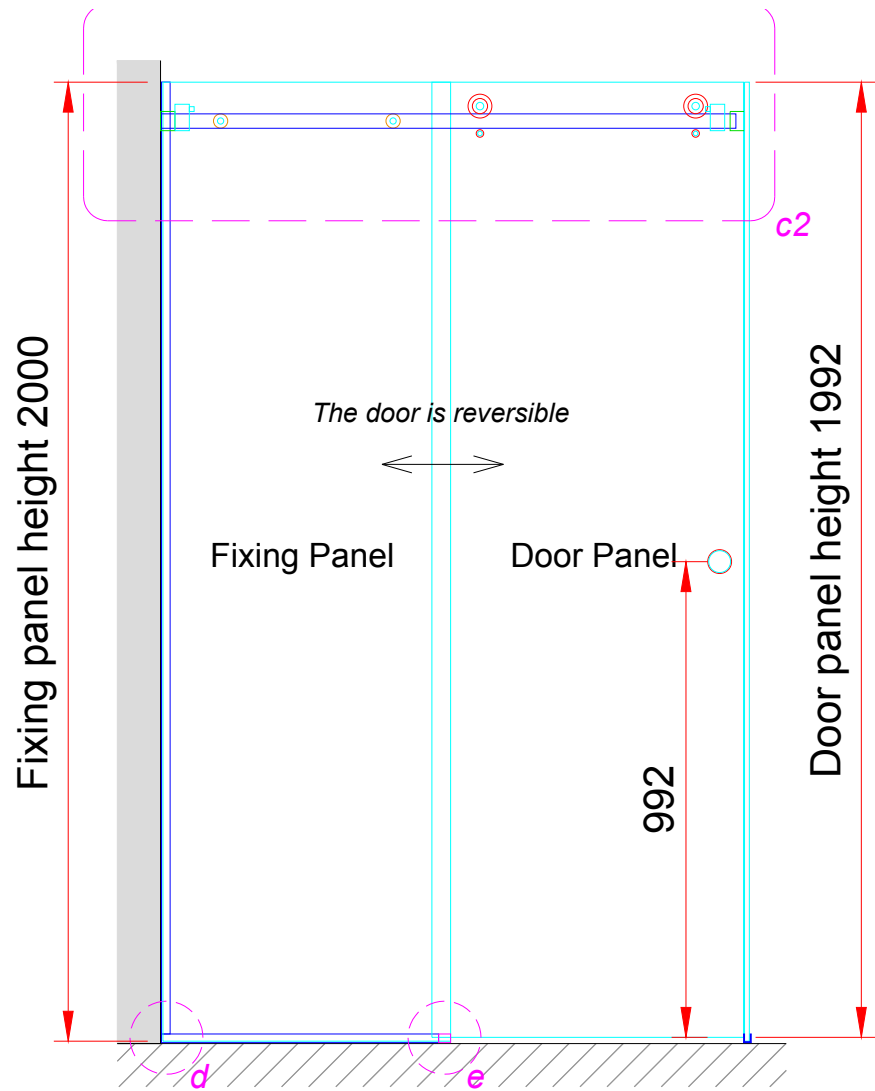

LEGEND	
1	Shower Channel
2	Sliding Bar
3	Upper Roller
4	Rail Connector
5	Stabiliser Guide
6	Stoppers
7	Rail to Wall Bracket
8	Rail to Glass Bracket
9	Door Ring
10	Floor Guide

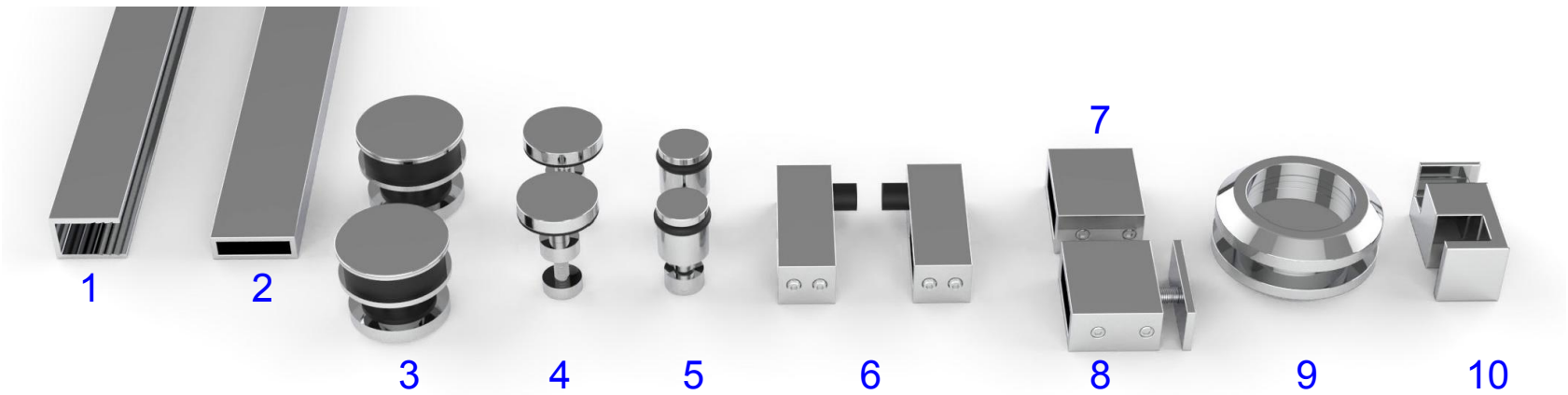

* Sliding Shower Hardware Pack

FIXING DETAIL(RECTANGLE)

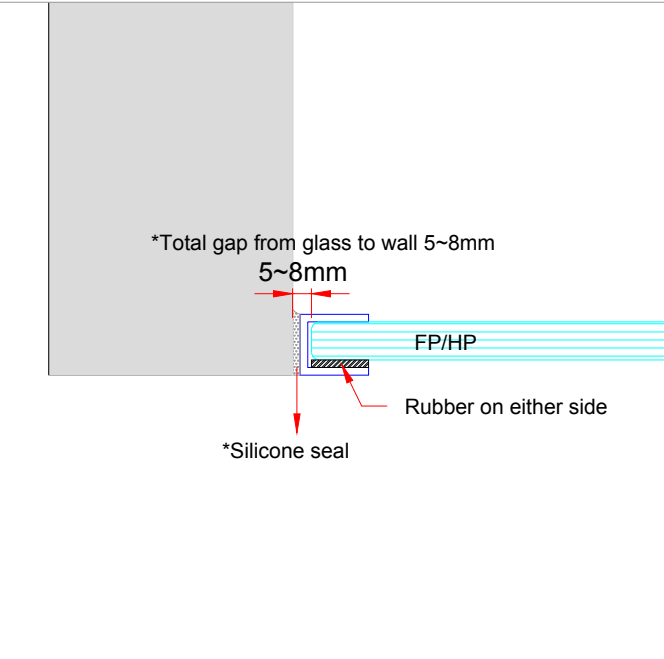

FIXING DETAIL a

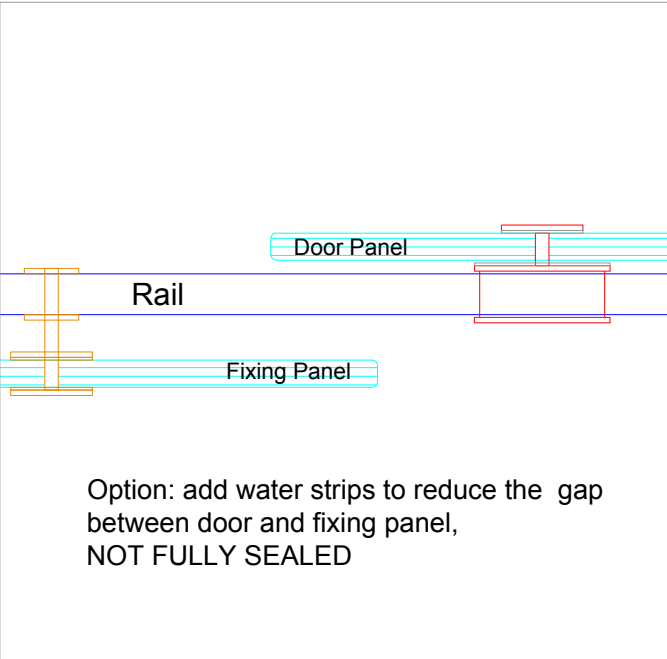

FIXING DETAIL b

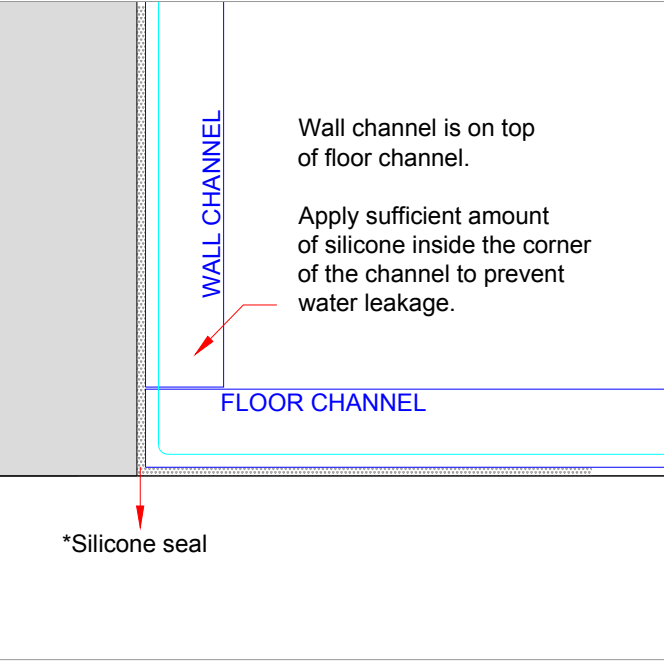

FIXING DETAIL d

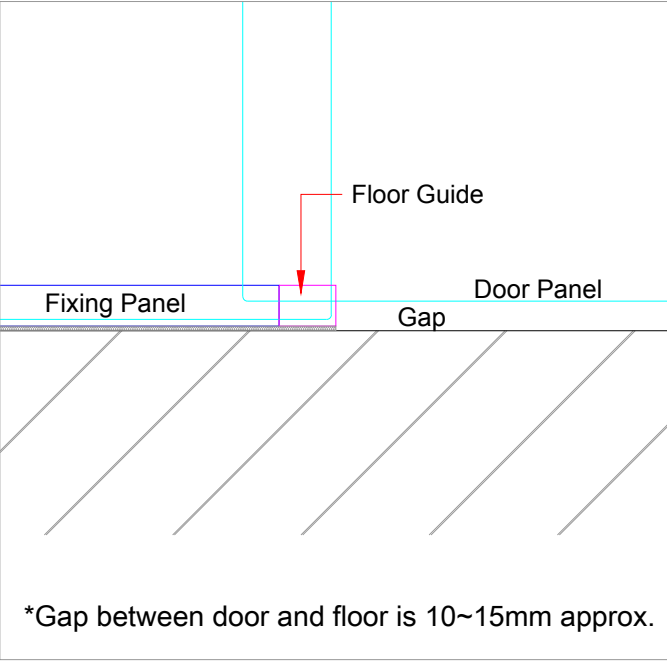

FIXING DETAIL e

Important:

Before you install your project, please read this installation guide carefully, consider the gap between each part, calculate the exact length before cutting.

The corners and edges of toughened glass are its weakest points, so ensure they are well-protected during installation.

Always use rubber spacers to separate stainless steel hardware from the glass to avoid damage.

After completing the installation, it is essential to clean both the glass and the hardware. Proper cleaning of the glass helps maintain its protective coating, and cleaning the hardware removes any metal debris from the installation process, preventing potential rust.

Additionally, regular cleaning afterward is recommended to ensure long-term durability and maintain optimal performance.

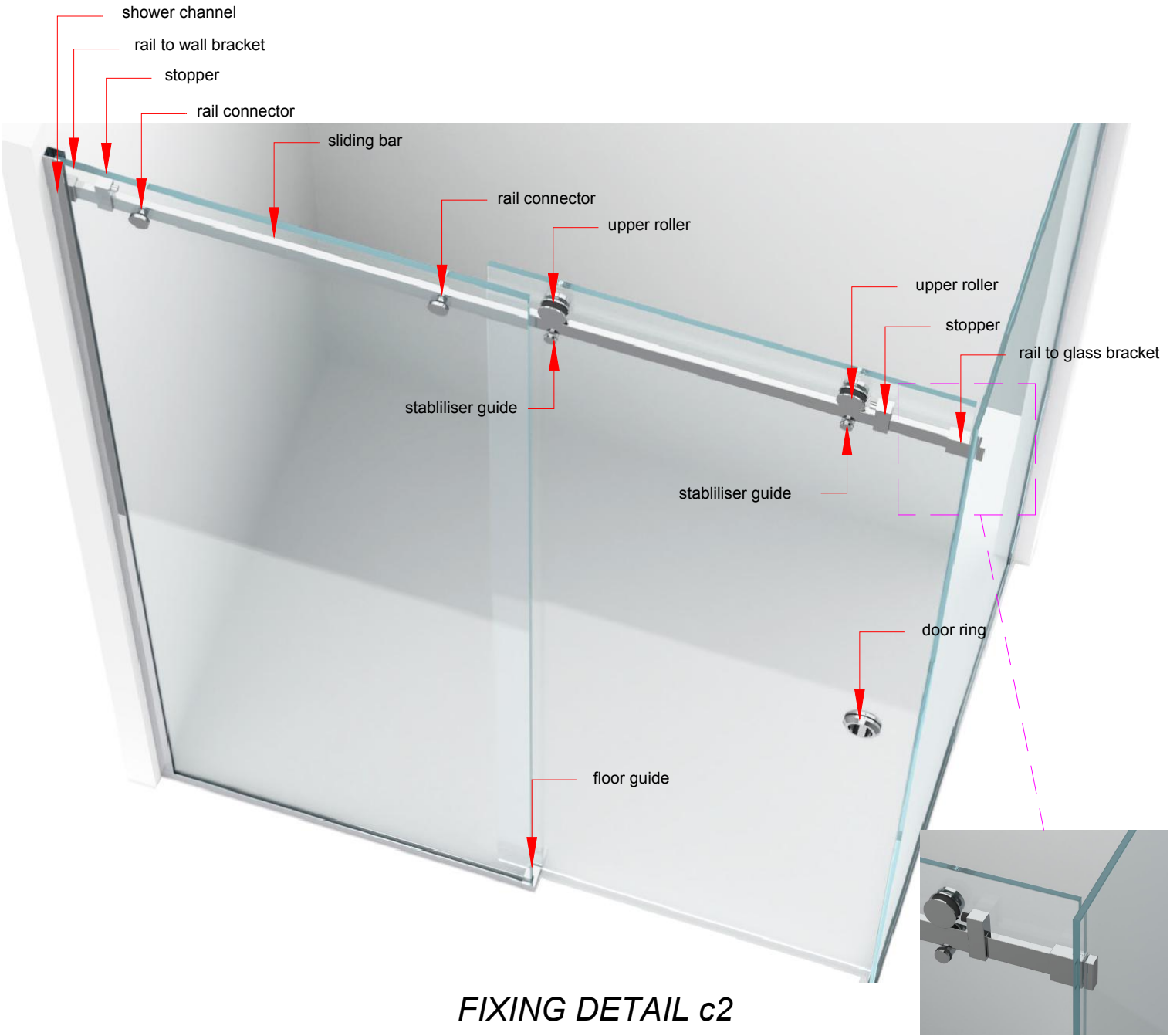

FIXING DETAIL c2